

## Building - Node

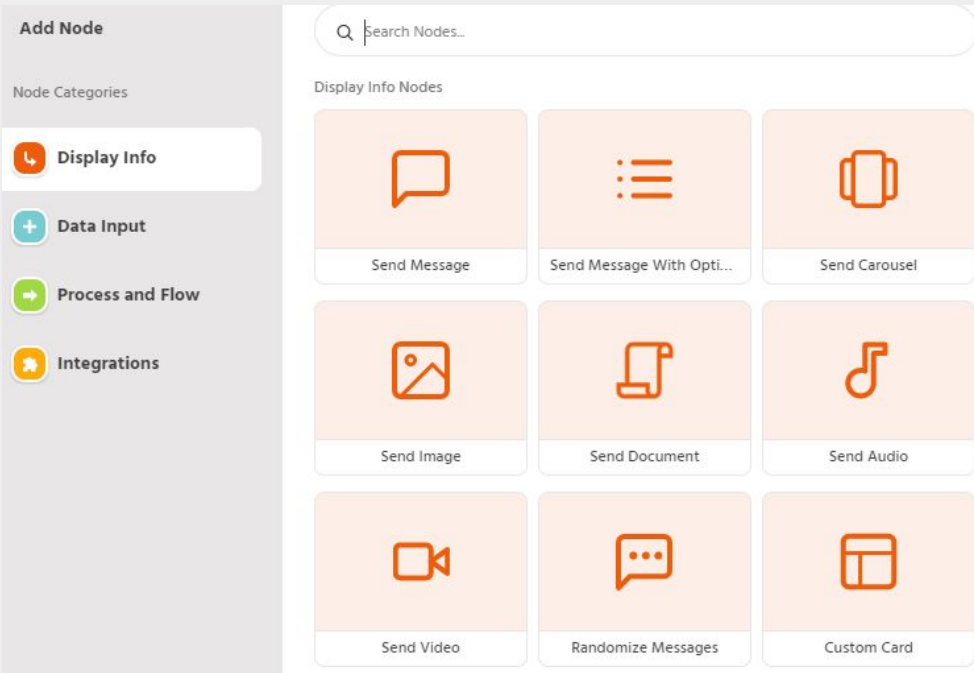
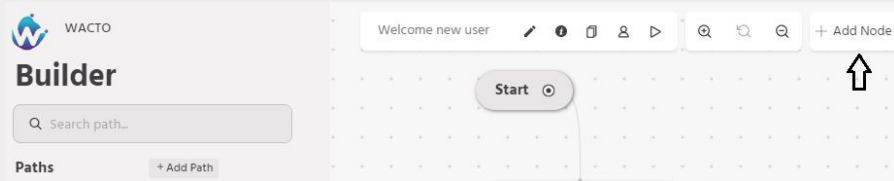

**Nodes are a building block of the conversation flow being designed as per the intended user journey for the chatbot's end user. The various types of Nodes provided include –**

**Display Information Nodes:** WACTO provides a number of options to present information to the end user via the chatbot. These range from simple messages, images, carousel cards & more

**Data Input Nodes:** Collecting information from engaging users is a key function of most chatbots. WACTO makes it easy to do the same by providing a number of options to collect data using nodes like Request User Data, Identity Node & more

**Processing Nodes:** WACTO also provides a number of ways to handle & process information within the chatbot and to make conversation flow branching decisions

**Integration Nodes:** WACTO has native integration with multiple apps including Salesforce, Google Calendar, Google Sheets

## Building

### Adding a Node

A node can be added by clicking on the 'Add node' present at the top of the builder flow.

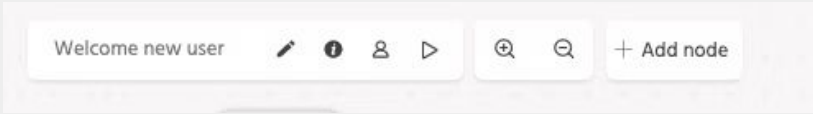

### Editing a Node

Hover over a node you'd like to edit to see the edit icon. Alternatively you can double tap on the node.



### Building Connections

You can drag a connection from one node to the other as shown below

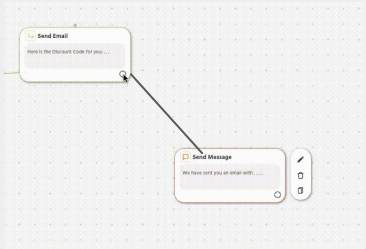

### Deleting a Node

Hover over the node you wish to delete and click on the bin icon



### Branching off to another Path

To redirect the flow to a different path, use the "Trigger Path" node and select the path that you would want the flow to be redirected to.

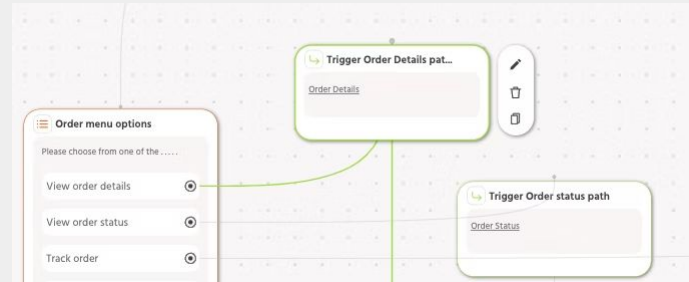

# Display information node - Send Message

Go to >> +Add Node >> Select Send Message >> Enter the message >> Click Save

Enter your Messages in message box ( You can able to add Bold, Userline, Standing, Link , Emojis in Content)

We have giving addition information of support formation

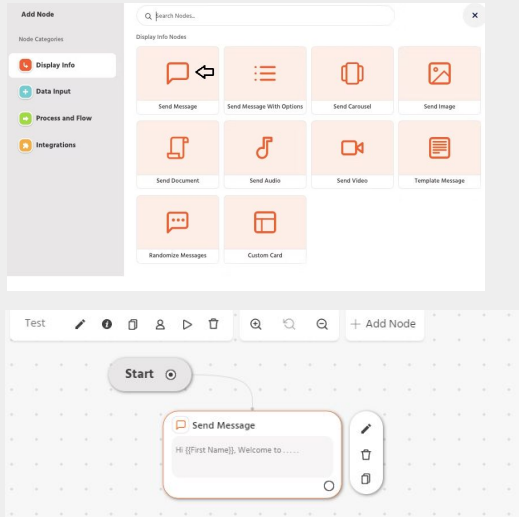
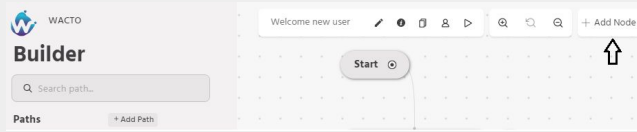

< Bots



bot duplicate

## Builder

Q Search path...

Paths + Add Path

Welcome new user

Greet returning user

Default Message

Post resolution

Agent Unavailable

Test

Send Message

Enter your message to be sent here. Use curly braces to refer to user inputs or parameters. For example - {{ First Name }}

Supported on 13 Channels

Message

Hi {{ First Name }},

Welcome to WACTO

B I U S 🗑️ 😊

Formatting Support

Formatting Support	B	I	U	+	🗑️
Webchat	✓	✓	✓	✓	✓
Whatsapp	✓	✓	-	✓	-
Facebook	-	-	-	-	-

Cancel

Save

# Display information node - Send Message with option

Go to >> +Add Node >> Select Send Message with option >>  
Enter the message & Create the option >> Click Save

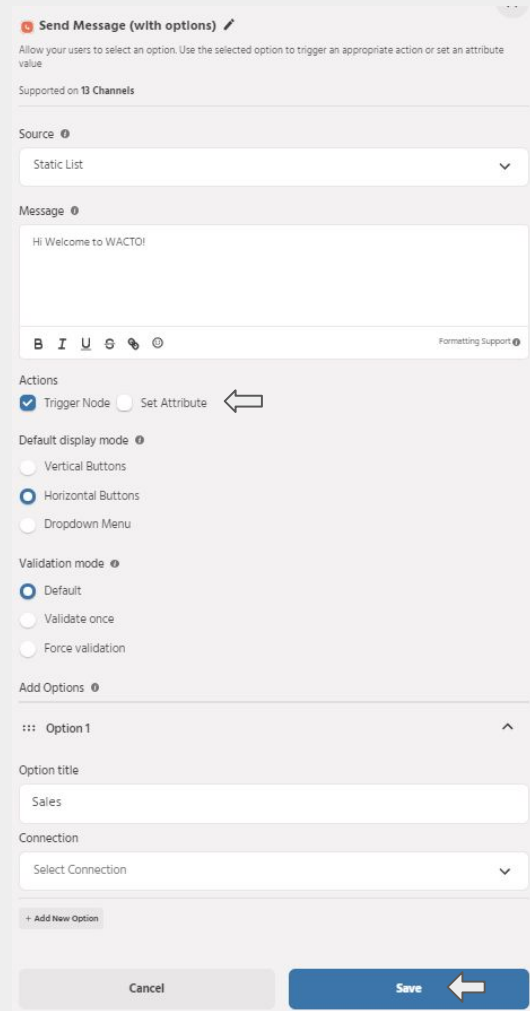
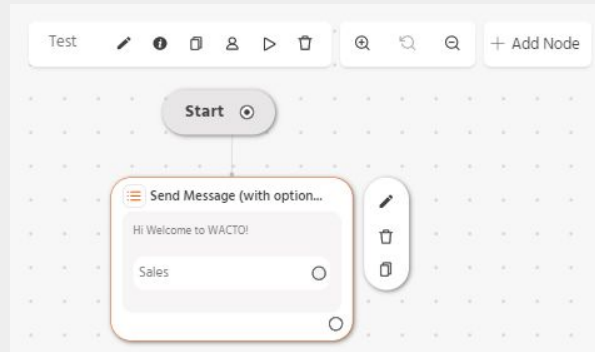
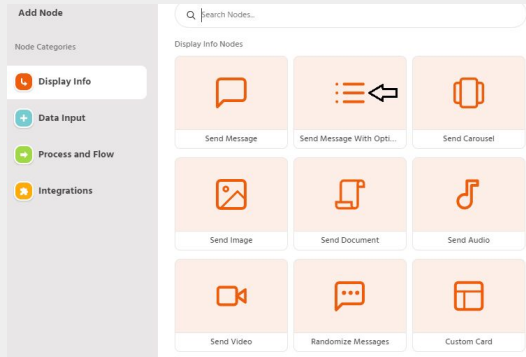
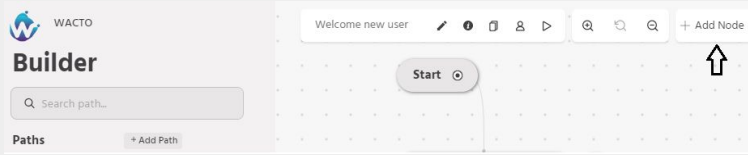

## Display information node - Send Carousel

The carousel option can be used to make interactive messages with images, text, subtext, URLs, and buttons.

Go to >> +Add Node >> Select Send carousel >> attach your images & enter the message & Create the option >> Click Save

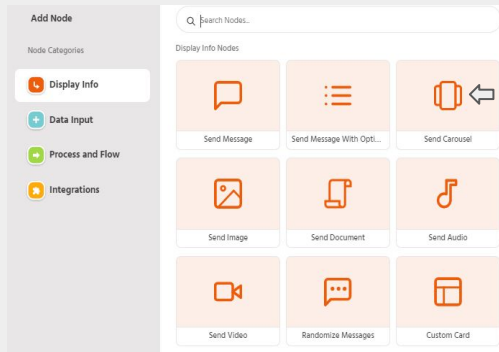

Separate sections - The image, title, description, and buttons have borders, dividing them into different sections in the card.

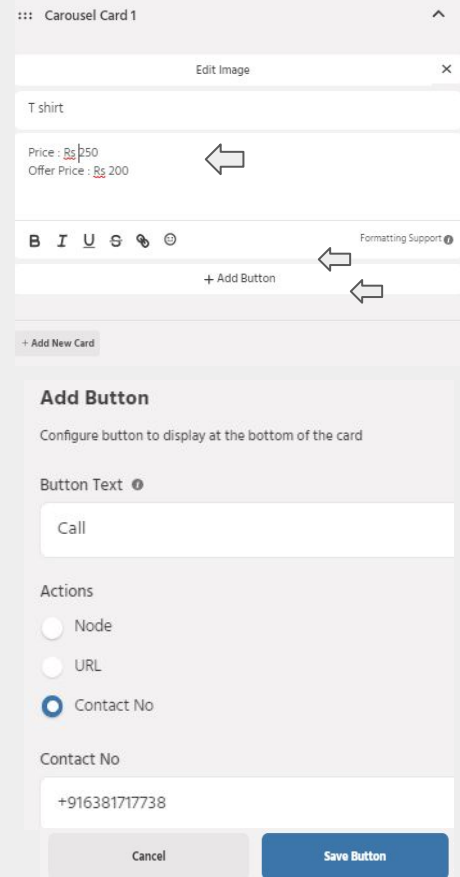
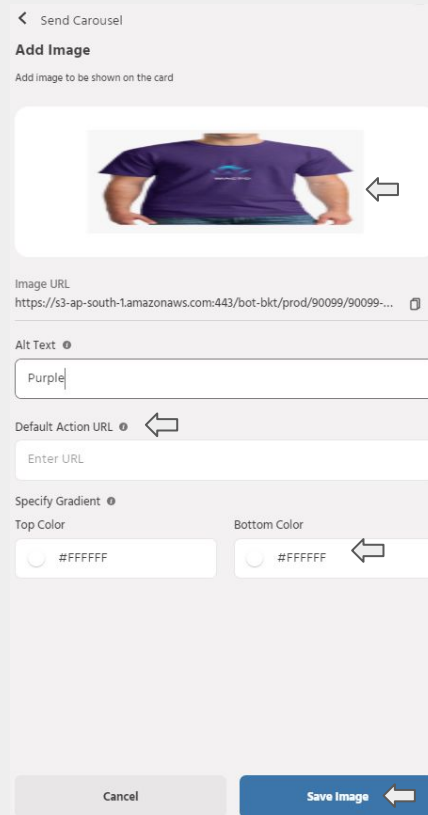
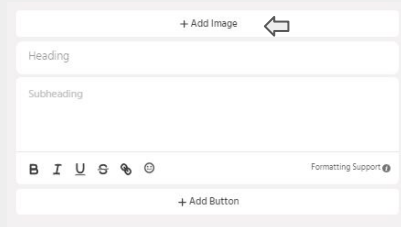

# Display information node - Send Carousel

## Send Carousel

Present your users with a carousel of cards. Configure appropriate action per the selected button.

Supported on 13 Channels

Card List Theme Styling

Source  
Static List - Add Individual Cards

Carousel Card 1

Edit Image

T shirt

Price : Rs 250  
Offer Price : Rs 200

B I U S Call

+ Add Button

+ Add New Card

Cancel Save

One at a Time: In this layout, one card is presented at a time. Users can scroll left or right using the next card button.

